

ITEM 22. WORKS ZONE – DANGAR PLACE CHIPPENDALE

TRIM RECORD NO: 2016/341016

RECOMMENDATION

It is recommended that the Committee endorse the reallocation of kerb space on the northern side of Dangar Place, Chippendale, between the points 37.5 metres and 49.5 metres (two car spaces) east of Wiley Street as “Works Zone 7.30am-5.30pm Mon-Fri, 7.30am-3.30pm Sat” and “No Parking At Other Times” subject to the following conditions:

- (A) The Applicant must comply with the Works Zone conditions as stipulated in Schedule D of this Agenda.
- (B) The temporary reallocation of kerb space on the southern side of Dangar Place, Chippendale, between the points 30.5 metres and 46.5 metres (three car spaces) east of Wiley Street as “No Parking 7.30am-5.30pm Mon-Fri, 7.30am-3.30pm Sat”.
- (C) The Applicant is not permitted to swing or hoist goods from a Works Zone across or over any part of a public road by means of a lift, hoist or crane unless a separate approval has been obtained from the City's Building Approvals Unit under Section 68 of the Local Government Act 1993.
- (D) The Applicant must notify local residents of the Works Zone at least seven days prior to installation.
- (E) The Applicant must provide a telephone number of the Site Manager.

VOTING MEMBERS FOR THIS ITEM

<i>Voting Members</i>	<i>Support</i>	<i>Object</i>
City of Sydney		
Roads and Maritime Services		
NSW Police – Redfern LAC		
Representative for the Member for Newtown		

DECISION

BACKGROUND

Profile Property Group Pty Ltd has applied for a 12 metre long Works Zone in Dangar Place, Chippendale.

The Works Zone is to facilitate construction works at 75-77 Myrtle Street, Chippendale for a period of approximately 24 weeks.

COMMENTS

The kerb space on the northern side of Dangar Place, Chippendale between Wiley and Abercrombie Streets, where the Works Zone is proposed, is currently signposted as “No Parking”.

Dangar Place is 6.5 metre wide (kerb-to-kerb) with on-street parking limited to the southern kerb only. The Works Zone however is proposed to be located on the northern kerb which will require the temporary removal of three on-street spaces along the southern kerb during the Works Zone hours of operation to maintain traffic flow.

Outside of the Works Zone hours of operation, the northern kerb space will revert back to "No Parking" and the southern kerb will revert back to unrestricted parking.

The Works Zone is intended to operate from 7.30am to 5.30pm, Monday to Friday and from 7.30am to 3.30pm on Saturdays in accordance with the Development Consent Conditions.

The development site has no provision for off-street parking for large trucks and as the approved development takes up the entire site, the Developer is unable to carry out construction unless a Works Zone is provided at the rear of the site. The street is wide enough to allow the Works Zone to be installed without affecting traffic flow or property access.

CONSULTATION

The Applicant must notify adjacent properties at least seven days prior to the implementation of the Works Zone.

FINANCIAL

All costs associated with the Works Zone will be borne by the Applicant.

ATTACHMENTS

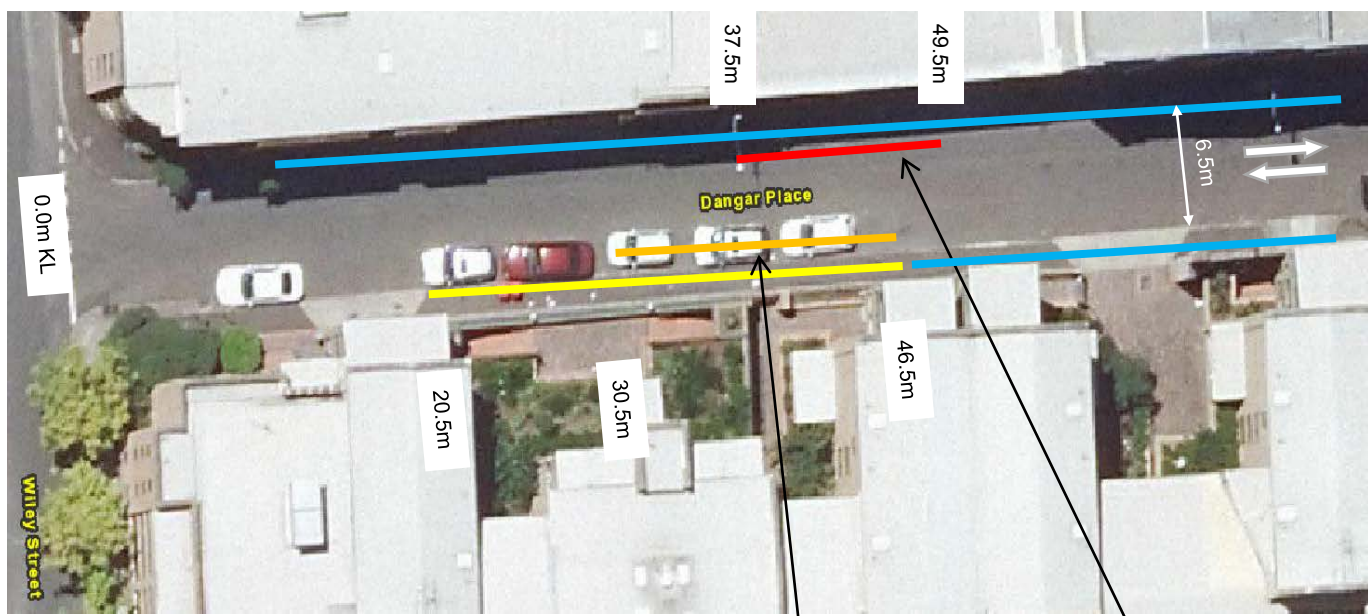

Works Zone – Dangar Place Chippendale

Ajay Nayyar, Traffic Works Coordinator

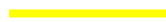

**Temporary
No Parking**

**Proposed
Works Zone**

-  Unrestricted Parking (Existing)
-  "No Parking" (Existing)
-  "Works Zone 7.30am-5.30pm Mon-Fri, 7.30am-3.30pm Sat" and "No Parking Other Times (Proposed)
-  "No Parking 7.30am-5.30pm Mon-Fri, 7.30am-3.30pm Sat" (Proposed)

PROPOSAL

**DANGAR PLACE, CHIPPENDALE
REQUEST FOR WORKS ZONE**

